

KEY

- **PROPOSED NO WAITING AT ANY TIME**
- **PROPOSED NO WAITING MONDAY-SATURDAY 08.30-18.30**
- ~ **REVOCATION OF EXISTING WAITING, LOADING AND PARKING RESTRICTIONS (NOT VISIBLE IF UNDER PROPOSALS)**
- **EXISTING WAITING, LOADING AND PARKING RESTRICTIONS (WITH OR WITHOUT SYMBOLS)**

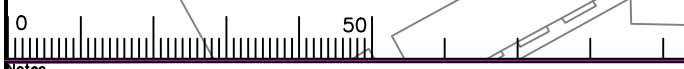
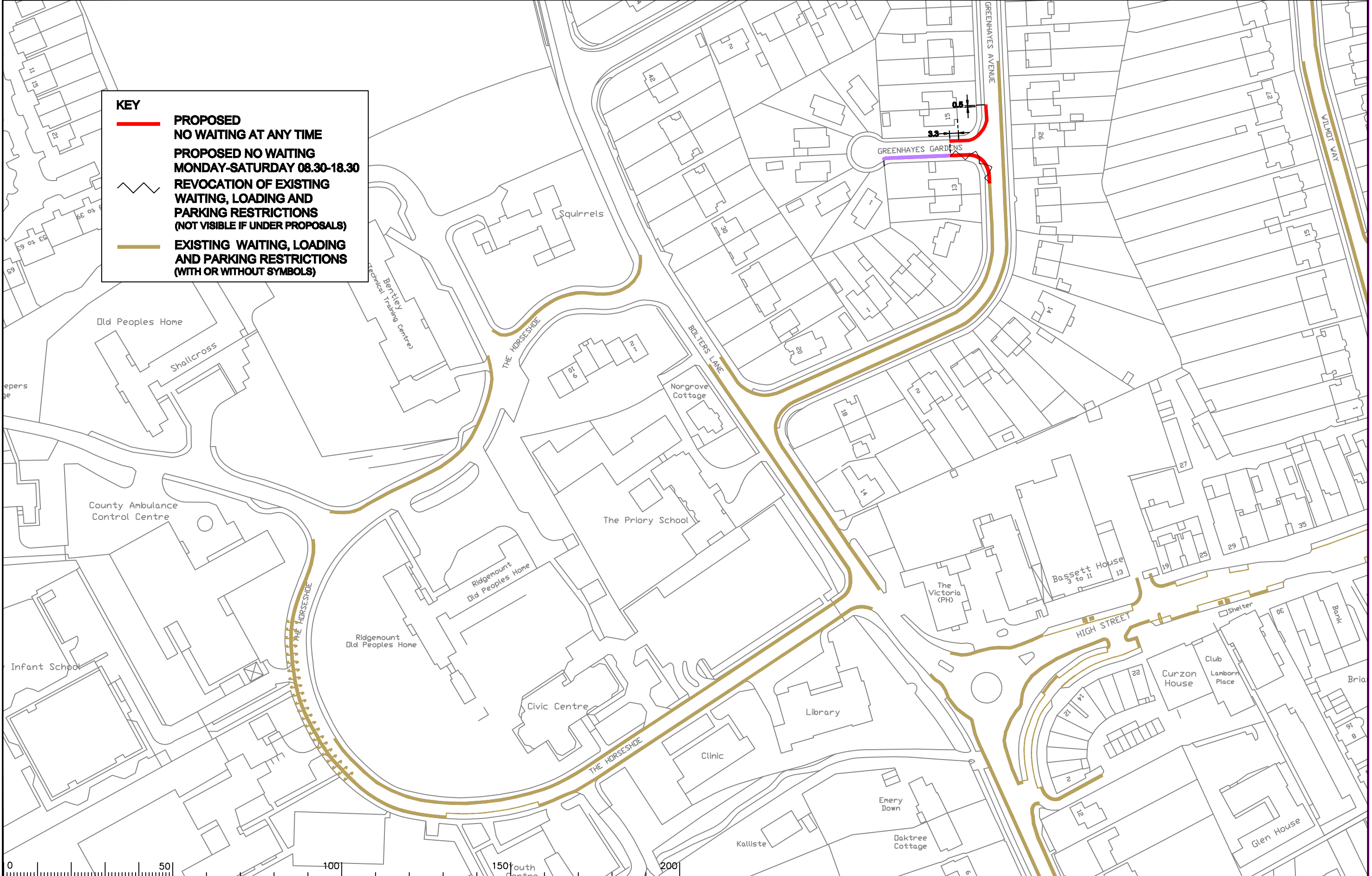

Notes

Rev.	Description	Drwn	Sig.	Date	Chkd	Sig.	Date	Appr	Sig.	Date
A	EXTRA RESTRICTIONS ADDED	CAH	CAH	08.11	AH	AH	08.11	TPC	TPC	08.11

Drawn by	Sig.	Date	Checked by	Sig.	Date	Approved by	Sig.	Date
SDC	SDC	07.07	TPC	TPC	07.07	TPC	TPC	07.07

North Point

Based upon the Ordnance Survey mapping with the permission of the Controller of Her Majesty's Stationery Office © Crown copyright. Unauthorised reproduction infringes Crown copyright and may lead to prosecution or civil proceedings. Surrey County Council LA 078872 1996.

Project: REIGATE AND BANSTEAD DPE BANSTEAD

Drawing: IMPLEMENTED TRAFFIC ORDERS

Project No. 3282/R&B

Contract Sheet No. 18008

Rev. A

Classification: ADVERTISED

SHEET OF

SURREY COUNTY COUNCIL
Sustainable Development
Head of Transportation
15, The Guildhall, Guildhall Square, Guildford, Surrey GU1 2DG

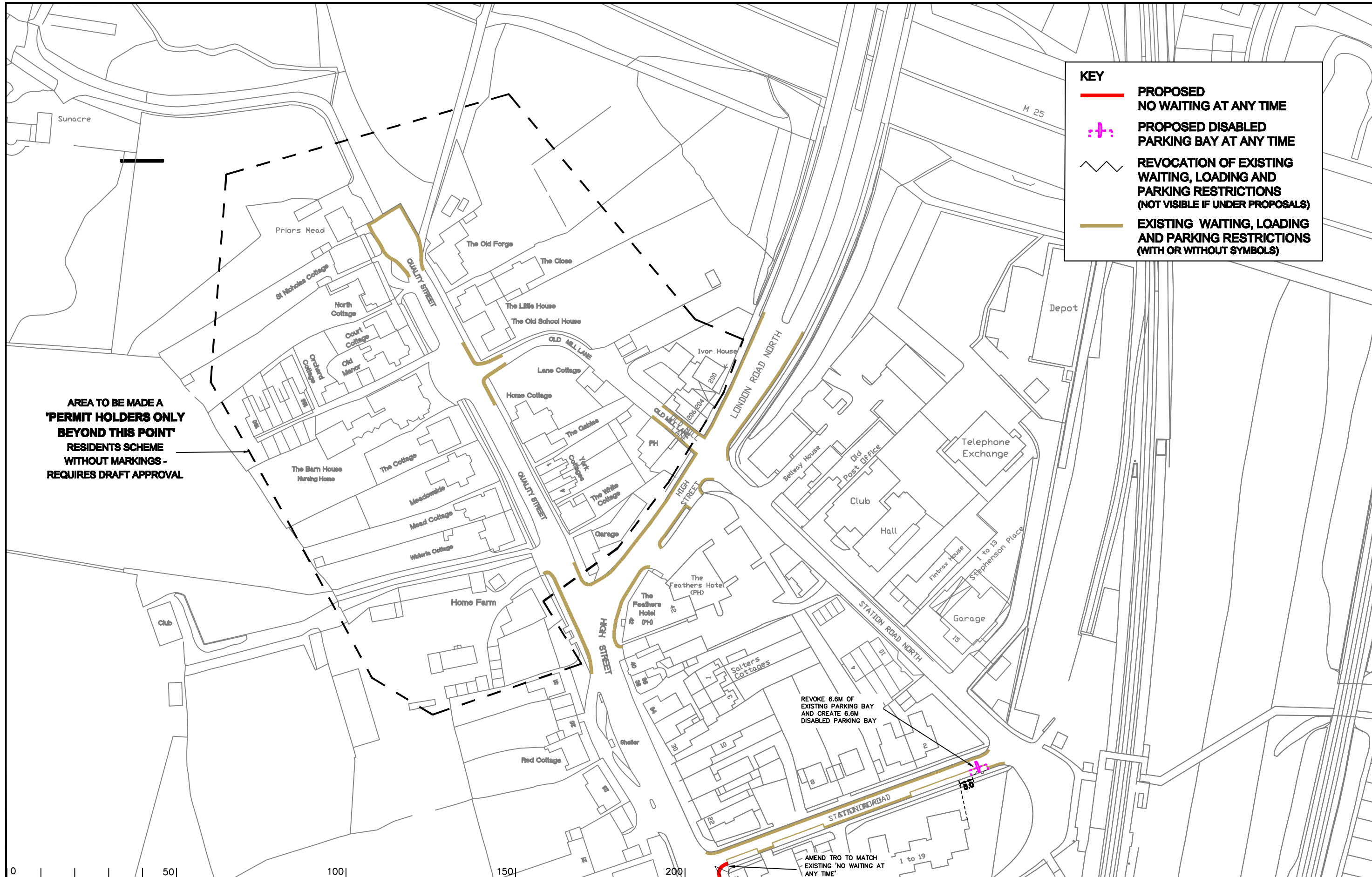

KEY

- PROPOSED NO WAITING AT ANY TIME
- - - PROPOSED DISABLED PARKING BAY AT ANY TIME
- REVOCATION OF EXISTING WAITING, LOADING AND PARKING RESTRICTIONS (NOT VISIBLE IF UNDER PROPOSALS)
- EXISTING WAITING, LOADING AND PARKING RESTRICTIONS (WITH OR WITHOUT SYMBOLS)

AREA TO BE MADE A 'PERMIT HOLDERS ONLY BEYOND THIS POINT' RESIDENTS SCHEME WITHOUT MARKINGS - REQUIRES DRAFT APPROVAL

REVOKE 6.6M OF EXISTING PARKING BAY AND CREATE 6.6M DISABLED PARKING BAY

AMEND TRO TO MATCH EXISTING 'NO WAITING AT ANY TIME'

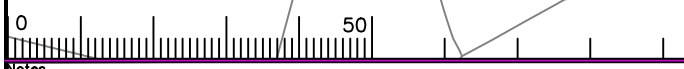

Notes

Rev.	Description	Drwn	Sig.	Date	Chkd	Sig.	Date	Appr	Sig.	Date
A	RESTRICTIONS ADDED	CAH	CAH	02.10	JP	JP	02.10	TPC	TPC	02.10
B	EXTRA RESTRICTIONS ADDED	CAH	CAH	08.11	AH	AH	08.11	TPC	TPC	08.11

Drwn	Sig.	Date	Chkd	Sig.	Date	Appr	Sig.	Date
CAH	CAH	02.10	JP	JP	02.10	TPC	TPC	02.10
CAH	CAH	08.11	AH	AH	08.11	TPC	TPC	08.11

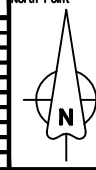

Based upon the Ordnance Survey mapping with the permission of the Controller of Her Majesty's Stationary Office © Crown copyright. Unauthorised reproduction infringes Crown copyright and may lead to prosecution or civil proceedings. Surrey County Council LA 078872 1998.

Drawn by	CAH	Sig.	CAH	Date	02.10
Checked by originator	JP	Sig.	JP	Date	02.10
Approved by	TPC	Sig.	TPC	Date	02.10

Project
REIGATE AND BANSTEAD DPE REDHILL

Drawing
IMPLEMENTED TRAFFIC ORDERS

SHEET OF

SURREY COUNTY COUNCIL
Sustainable Development

Project No.	3282/R&B
Contract Sheet No.	18046
Rev.	B
Classification	ADVERTISED

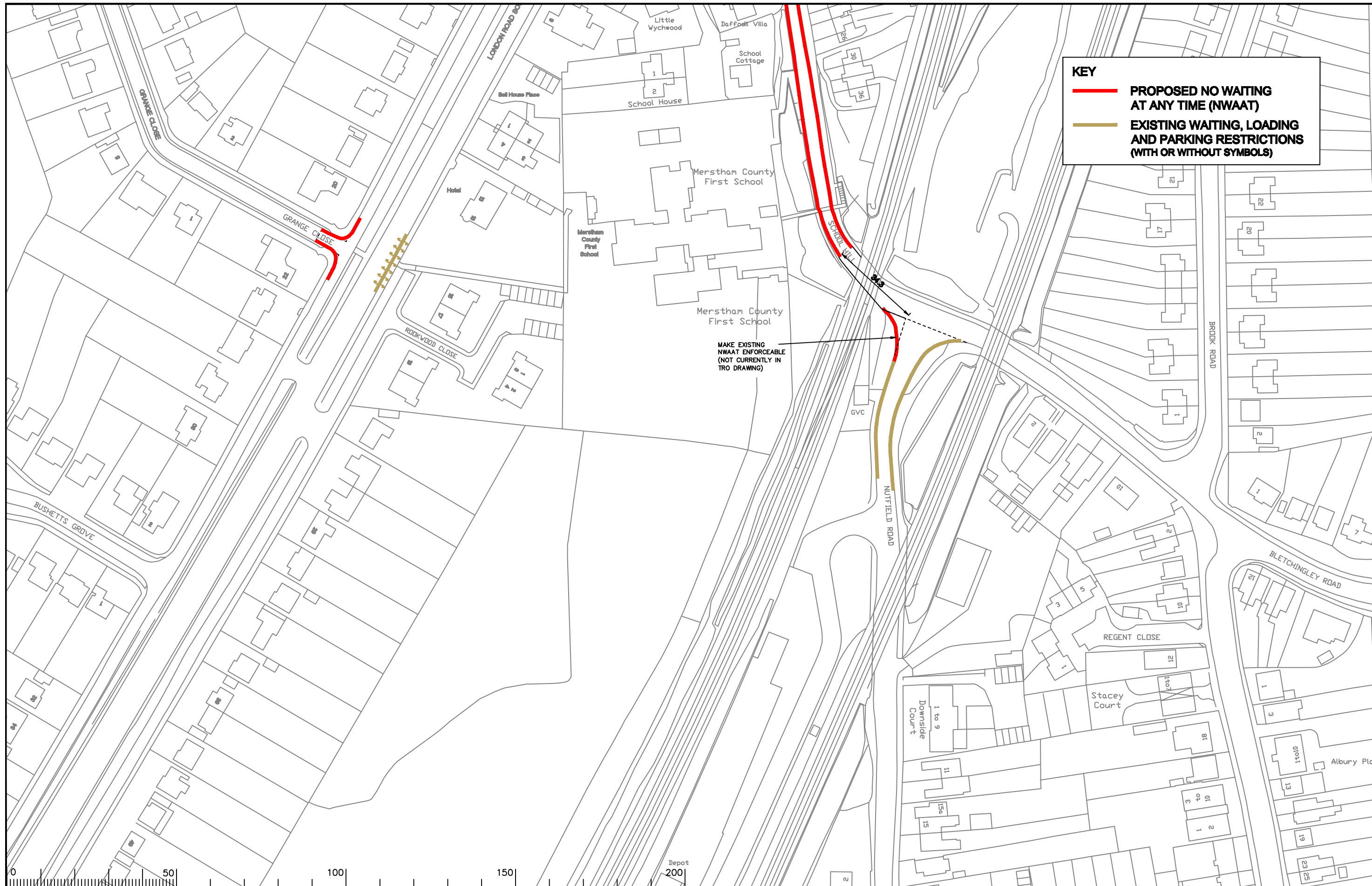

KEY

- PROPOSED NO WAITING AT ANY TIME (NWAAT)
- EXISTING WAITING, LOADING AND PARKING RESTRICTIONS (WITH OR WITHOUT SYMBOLS)

MAKE EXISTING NWAAT ENFORCEABLE (NOT CURRENTLY IN TRO DRAWING)

Notes

Rev.	Description	Drwn	Sig.	Date	Chkd	Sig.	Date	Appr	Sig.	Date
A	RESTRICTIONS AMENDED	CAH	CAH	08.11	AH	AH	08.11	TPC	TPC	08.11

Drwn	Sig.	Date	Chkd	Sig.	Date	Appr	Sig.	Date
CAH	CAH	08.11	AH	AH	08.11	TPC	TPC	08.11

North Point

Based upon the Ordnance Survey mapping with the permission of the Controller of Her Majesty's Stationery Office © Crown copyright. Unauthorised reproduction infringes Crown copyright and may lead to prosecution or civil proceedings. Surrey County Council LA 078872 1998.

Drawn by	SDC	Sig.	SDC	Date	07.07
Checked by originator	TPC	Sig.	TPC	Date	07.07
Approved by	TPC	Sig.	TPC	Date	07.07

Project

REIGATE AND BANSTEAD DPE REDHILL

Drawing

IMPLEMENTED TRAFFIC ORDERS

SHEET OF

SURREY COUNTY COUNCIL
Sustainable Development

Project No. 3282/R&B
Contract Sheet No. 18049
Drawing No. 18049
Rev. A

Classification
ADVERTISED

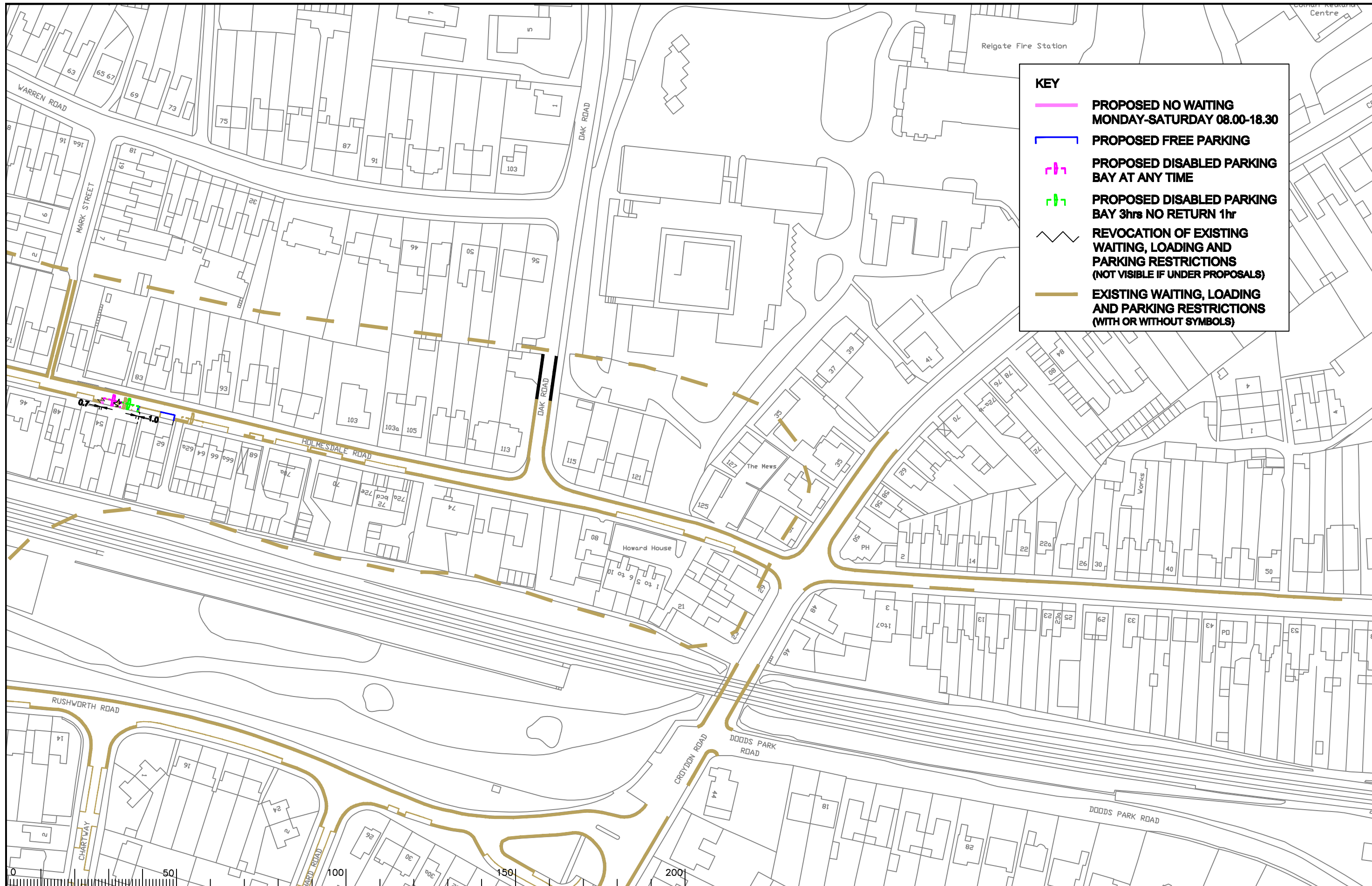

KEY

- PROPOSED NO WAITING MONDAY-SATURDAY 08.00-18.30
- PROPOSED FREE PARKING
- ⇄ PROPOSED DISABLED PARKING BAY AT ANY TIME
- ⇄ PROPOSED DISABLED PARKING BAY 3hrs NO RETURN 1hr
- ~ REVOCATION OF EXISTING WAITING, LOADING AND PARKING RESTRICTIONS (NOT VISIBLE IF UNDER PROPOSALS)
- - - EXISTING WAITING, LOADING AND PARKING RESTRICTIONS (WITH OR WITHOUT SYMBOLS)

Notes

Rev.	Description	Drwn	Sig.	Date	Chkd	Sig.	Date	Appr	Sig.	Date
A	AMENDMENTS MADE TO RESTRICTIONS	SDC	SDC	30.04.08	TPC	TPC	30.04.08	TPC	TPC	30.04.08
B	EXTRA RESTRICTIONS ADDED	CAH	CAH	08.11	AH	AH	08.11	TPC	TPC	08.11

Drawn by	Sig.	Date
SDC	SDC	07.07
Checked by originator	Sig.	Date
TPC	TPC	07.07
Approved by	Sig.	Date
TPC	TPC	07.07

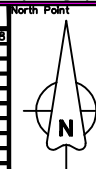

Project: REIGATE AND BANSTEAD DPE REIGATE

Drawing: IMPLEMENTED TRAFFIC ORDERS

Project No. 3282/R&B

Contract Sheet No. 18081

Rev. B

Classification: ADVERTISED

SHEET OF



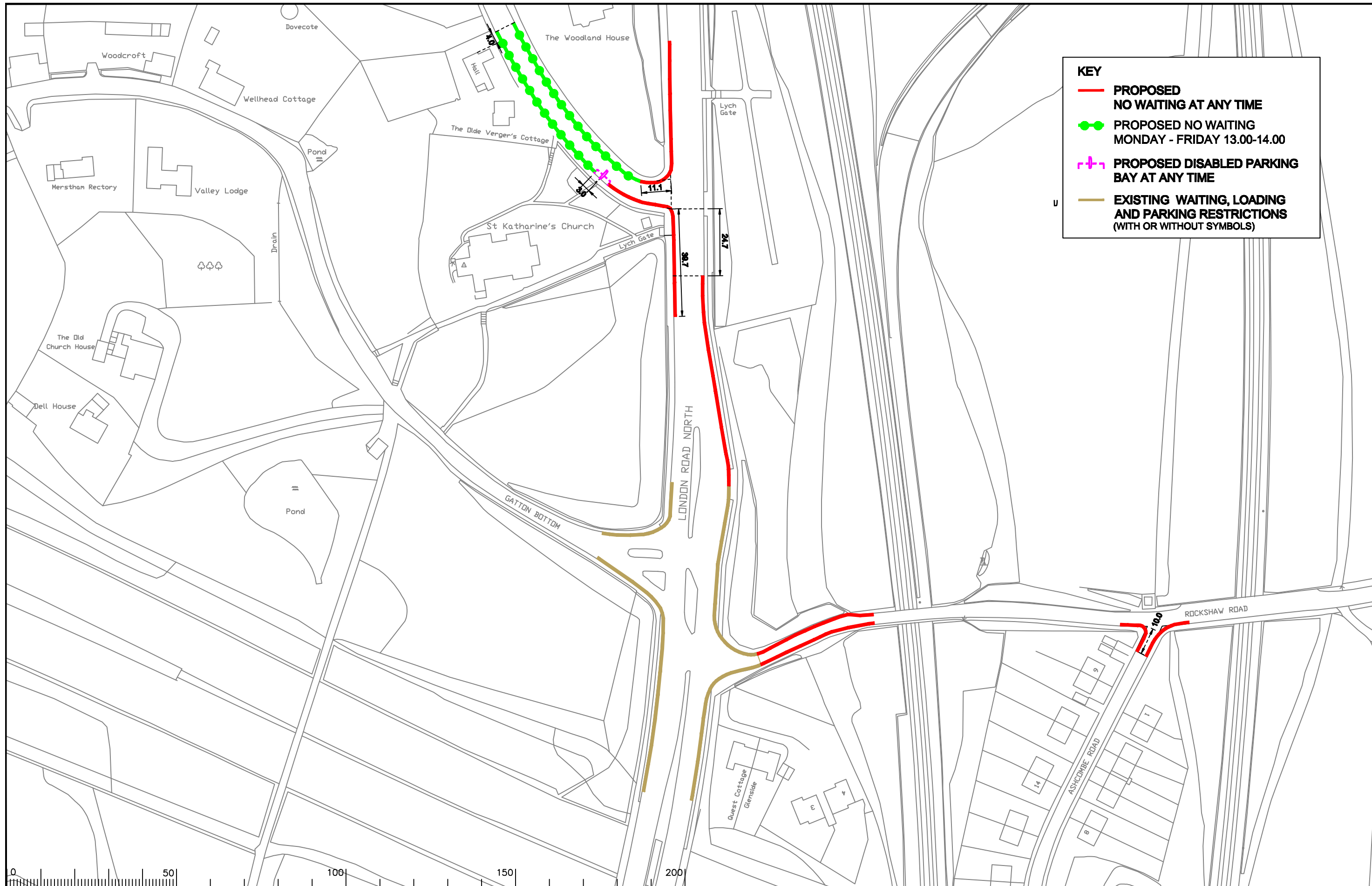

KEY

- **PROPOSED NO WAITING AT ANY TIME**
- **PROPOSED NO WAITING MONDAY - FRIDAY 13.00-14.00**
- + **PROPOSED DISABLED PARKING BAY AT ANY TIME**
- **EXISTING WAITING, LOADING AND PARKING RESTRICTIONS (WITH OR WITHOUT SYMBOLS)**

Notes

Rev.	Description	Drwn	Sig.	Date	Chkd	Sig.	Date	Appr	Sig.	Date
A	RESTRICTIONS AMENDED - JUNE COMMITTEE	CAH	CAH	05.10	JP	JP	05.10	TPC	TPC	05.10
B	EXTRA RESTRICTIONS ADDED	CAH	CAH	08.11	AH	AH	08.11	TPC	TPC	08.11

North Point

Based upon the Ordnance Survey mapping with the permission of the Controller of Her Majesty's Stationery Office © Crown copyright. Unauthorised reproduction infringes Crown copyright and may lead to prosecution or civil proceedings. Surrey County Council LA 078872 1996.

Drawn by: CAH, Date: 02.10
 Checked by originator: JP, Date: 02.10
 Approved by: TPC, Date: 02.10

Project: REIGATE AND BANSTEAD DPE REDHILL

Drawing: IMPLEMENTED TRAFFIC ORDERS

SURREY COUNTY COUNCIL
 Sustainable Development

Project No. 3282/R&B
 Contract Sheet No. 18134
 Drawing No. 18134
 Rev. B
 Classification: ADVERTISED

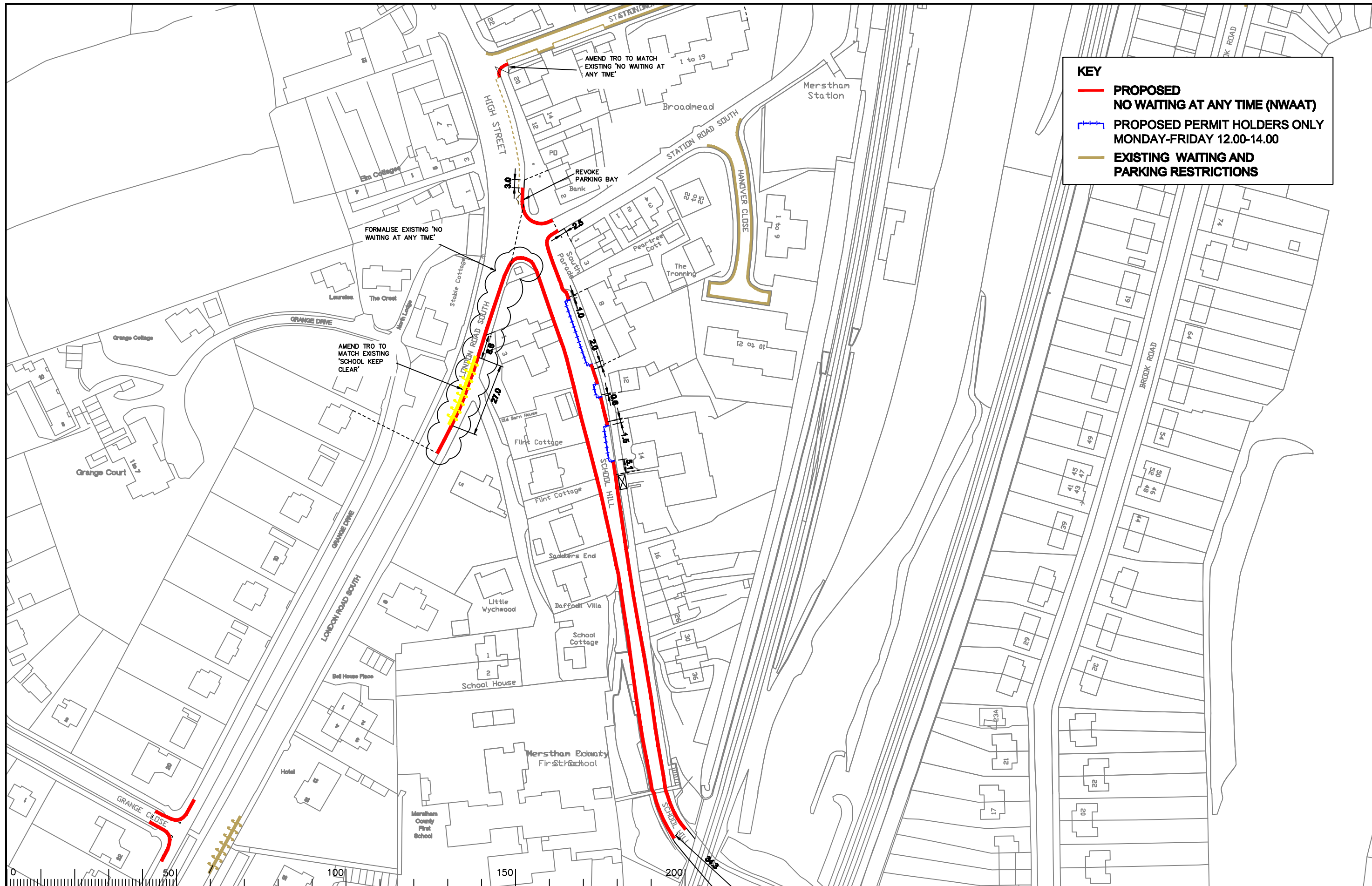

KEY

- **PROPOSED NO WAITING AT ANY TIME (NWAAT)**
- - - **PROPOSED PERMIT HOLDERS ONLY MONDAY-FRIDAY 12.00-14.00**
- - - **EXISTING WAITING AND PARKING RESTRICTIONS**

Notes

Rev.	Description	Drwn	Sig.	Date	Chkd	Sig.	Date	Appr	Sig.	Date

North Point

Drawn by	CAH	Sig.	CAH	Date	08.11
Checked by	AH	Sig.	AH	Date	08.11
Approved by	TPC	Sig.	TPC	Date	08.11

Project
REIGATE AND BANSTEAD DPE REDHILL
 Drawing
IMPLEMENTED TRAFFIC ORDERS

SURREY
 COUNTY COUNCIL
 Sustainable Development

Project No. 3282/R&B
 Contract Sheet No. 18148
 Drawing No. 18148
 Rev. -
 Classification
ADVERTISED